

Platypus Sprinkler Manual

<i>Platypus Sprinkler Specifications</i>	<i>3</i>
<i>Sprinkler Assembly and Cleaning Instructions</i>	<i>4</i>
<i>Flow Control Insert Specifications</i>	<i>6</i>
<i>System Maintenance</i>	<i>7</i>
<i>Warranty</i>	<i>8-11</i>

Platypus Fire Pty Ltd
makers of the



**PLATYPUS[®]
CONTROLLER**

and



**PLATYPUS[®]
SPRINKLER**

The Sensible Bushfire Protection System

Platypus Fire Pty Ltd makers of the



The Sensible Bushfire Protection System

Thank you for purchasing the Platypus Sprinkler.

This product is supported by a 12 month warranty.

This illustration (below) shows the recommended sprinkler installation range (see Mounting and Installation Diagrams for further information).

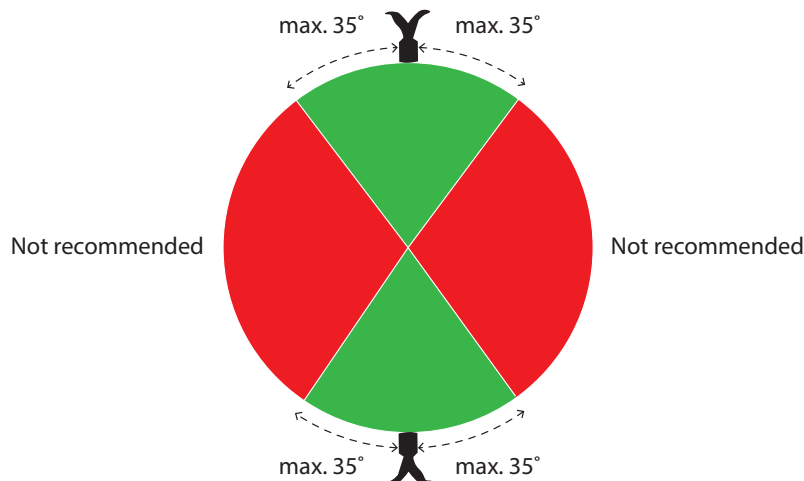

An operating pressure of 300 kpa to 350 kpa at the sprinkler head is ideal.

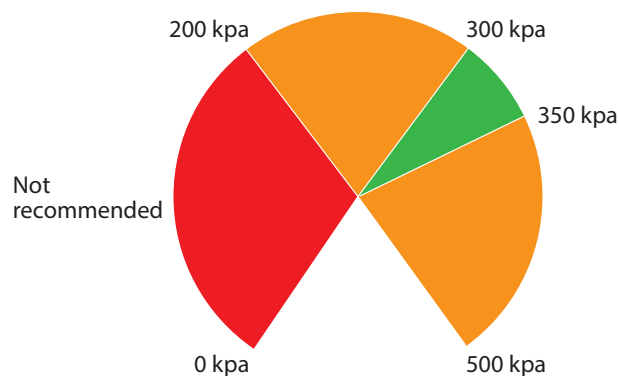

Note - Due to manufacturing processes you may see some sprinklers start to run earlier than others. There may also be minor differences in the running speed of the sprinkler head, this does not indicate a faulty product.



Sprinkler specifications



- Overall height of the sprinkler is 81mm (A)
- Width at the widest point is 51mm (B)
- Weight is 85 grams
- Inlet 1/2" BSP thread

Construction:

Sprinkler Head

- Glass reinforced nylon with flame retardant and UV stabiliser, designed to meet UL94 - V1 @ 1.6mm

Inlet Shaft and Nozzle

- 316 stainless steel

Bearing

- PTFE with graphite and carbon fibre



Sprinkler assembly and cleaning instructions

JANUARY 2021 ONWARDS

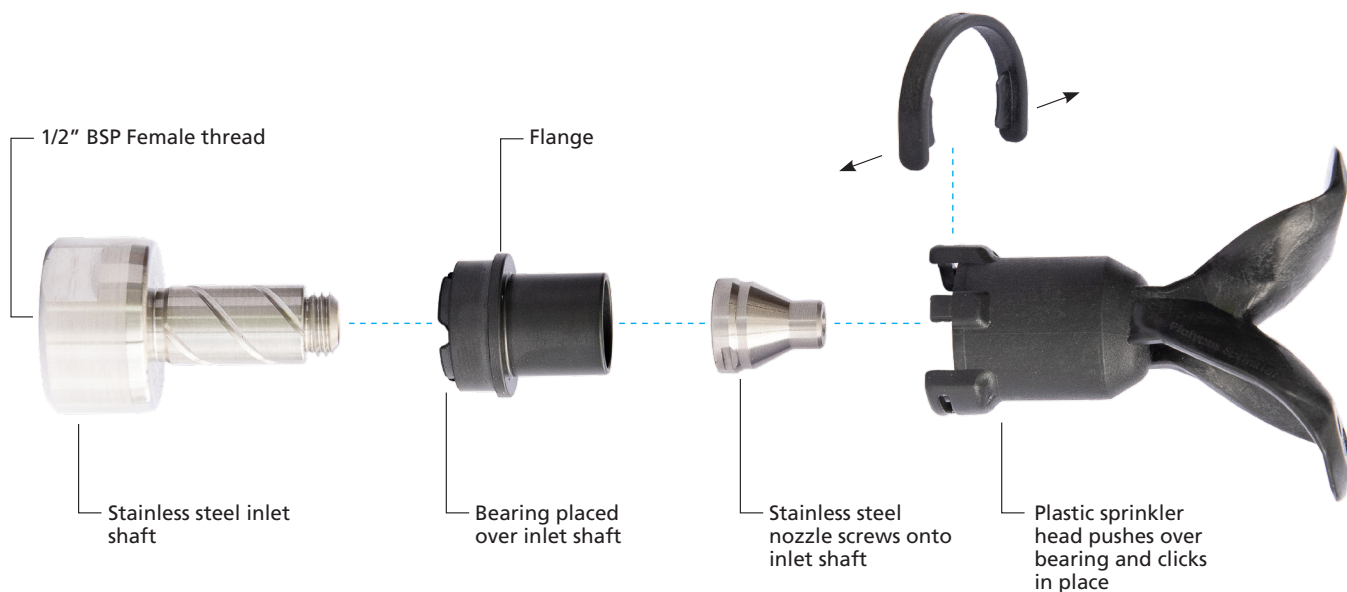

1. To remove sprinkler head spread the retaining clip outwards to release from grooves in sprinkler head, hold inlet shaft firmly and pull head upwards away from shaft. The nozzle can then be removed by using a 1/2" open end spanner on the flat edges and twisting in an anti-clockwise direction "**ensure**" spanner fits correctly onto the flat edges either side of the nozzle taking care not to leave any burrs that may catch on the sprinkler head and or bearing.
2. After nozzle is removed lift bearing of shaft, clean the shaft, bearing & nozzle using clean water **DO NOT USE SOLVENTS OR LUBRICANTS.**
3. When re-assembling slide bearing back onto shaft, screw nozzle on in clockwise direction and tighten using 1/2" spanner **DO NOT OVER TIGHTEN.** Push sprinkler head down onto bearing ensuring that its all the way down onto the flange of the bearing, spread retaining clip outwards and refit into grooves of sprinkler head.
4. Check to ensure sprinkler head spins freely.

NOTE: ENSURE THE SAME BEARING AND HEAD ARE FITTED BACK ONTO ITS ORIGINAL INLET SHAFT.



Sprinkler assembly and cleaning instructions

PRIOR TO DECEMBER 2020

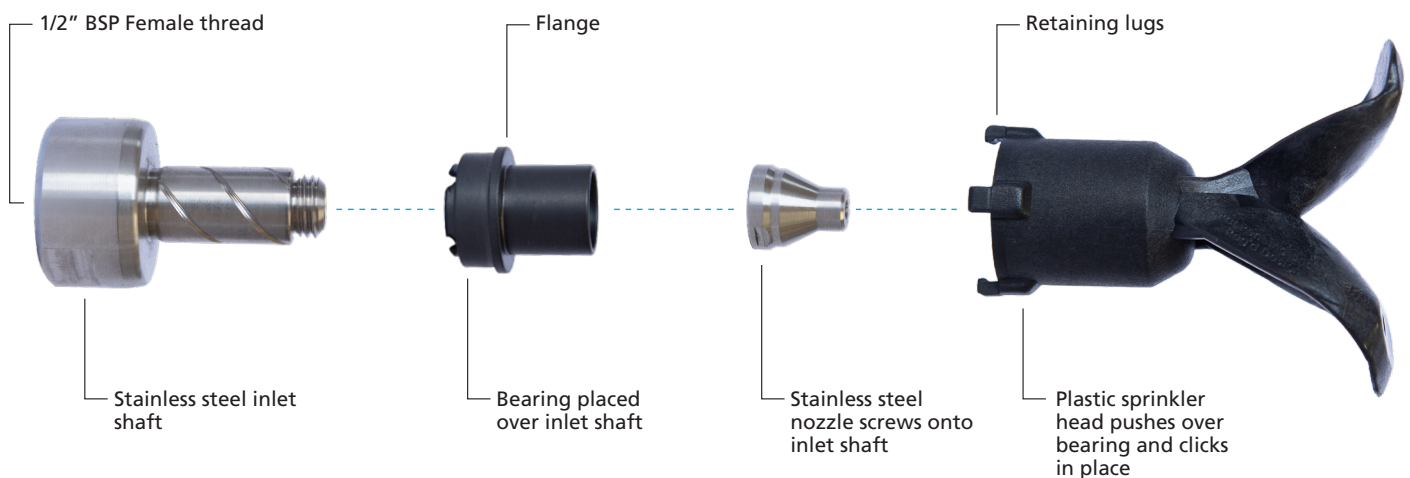

1. To remove sprinkler head hold inlet shaft firmly and pull head upwards away from shaft. The nozzle can then be removed by using a 1/2" open end spanner on the flat edges and twisting in an anti-clockwise direction "**ensure**" spanner fits correctly onto the flat edges either side of the nozzle taking care not to leave any burrs that may catch on the sprinkler head and or bearing.
2. After nozzle is removed lift bearing of shaft, clean the shaft, bearing & nozzle using clean water **DO NOT USE SOLVENTS OR LUBRICANTS.**
3. When re-assembling slide bearing back onto shaft, screw nozzle on in clockwise direction and tighten using 1/2" spanner **DO NOT OVER TIGHTEN.** Push sprinkler head down onto bearing ensuring that retaining lugs click over flange of bearing.
4. Check to ensure sprinkler head spins freely.

NOTE: ENSURE THE SAME BEARING AND HEAD ARE FITTED BACK ONTO ITS ORIGINAL INLET SHAFT.



Flow control insert data sheet

Length overall:	17mm
Outside diameter:	15mm
Flow rate:	5.5lpm to suit 2.5mm nozzle or 9lpm to suit 3.2mm nozzle, not available for 4.0mm nozzle
Maximum working temp:	80°C
Flow rate accuracy:	+or- 10% at 140 – 1000kpa

Valve must be installed the right way around or immediate failure may result. A direction of flow insert is stamped on the outside diameter of the flow control insert.

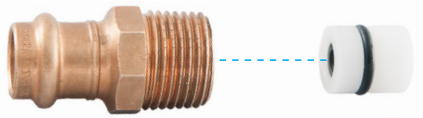

- Flow Control Insert fits into the Viega crimp-on male adaptor

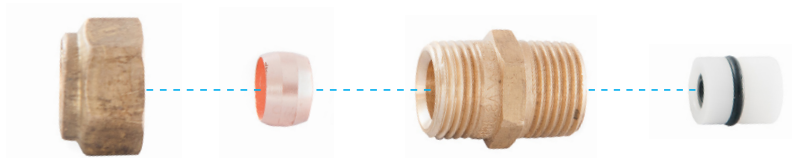

- Flow Control Insert fits into the copper olive male union

Note: Copper olive union has been machined to suit Flow Control Insert

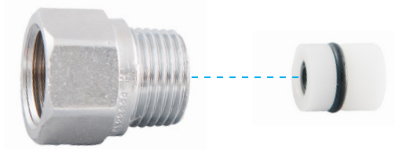

- Flow Control Insert fits into the chrome brass M&F adaptor

Note: Chrome brass M&F adapter has been machined to suit Flow Control Insert



- Direction of water flow through the flow control insert



System Maintenance

Platypus Fire PL recommends you carry out regular maintenance to ensure reliable operation of your sprinkler system and associated equipment.

YEARLY - PRIOR TO BUSHFIRE SEASON

- Remove, clean and inspect sprinkler shaft, bearing & heads
- Service engine according to manufacturer's guidelines
- Test operation of back up generator and or power supply
- Change fuel in petrol engines
- Check & clean inline strainers
- Check water level in tank & level indicator
- Visual check of pipework
- Check controller using test function
- Check & clean gutters, downpipes & strainer basket
- Check operation of mains water top up
- Start pump & check operation of system
(flush system with clean water if using pool water and or bore water etc)
- Prepare, discuss and organize your bushfire survival plan

MONTHLY DURING BUSHFIRE SEASON

- Start pump and check operation of system
- Check controller using test function
- Start pump & check operation of system
(flush system with clean water if using pool water and or bore water etc)
- Check water level in tank & level indicator
- Visual check of pipework & sprinkler heads
- Check strainer basket in tank is clear

QUARTERLY

- Start pump & check operation of system
- Check controller using test function
- Visual check of pipework & sprinkler heads

The above guide is suggested as minimum requirements, a maintenance schedule specific to your system should be established at or before installation.

Due to the unpredictable nature & timing of bushfires it is important that you and your system are prepared at all times.



Product Warranty

1. DEFINITIONS

1.1 In this Warranty the following definitions apply:

Date of Purchase has the meaning set out in clause 3.2.

Platypus means Platypus Fire Pty Ltd (ACN 159 992 355) of PO Box 466, Trafalgar VIC 3824 Australia.

Purchaser means the purchaser of the Platypus Sprinkler.

Sprinkler means the Platypus Sprinkler including the following sprinkler models:

- a) Model PFSS25;
- b) Model PFSS32;
- c) Model PFSS40.

Return of Goods Authorisation Number means the number allocated by Platypus to a claim for the return of the Sprinkler.

Term has the meaning set out in clause 3.1.

Warranty means this Platypus Sprinkler Product Warranty.

2. GENERAL

2.1 Our products come with guarantees that cannot be excluded under the Australia Consumer Law. You are entitled to a replacement or refund for a major failure and compensation for any other reasonably foreseeable loss or damage. You are also entitled to have the goods repaired or replaced if the goods fail to be of acceptable quality and the failure does not amount to a major failure.



- 2.2 This Warranty gives the purchaser additional protection for the Sprinkler and provides a procedure for making a claim under the Warranty.
- 2.3 Nothing in this Warranty purports to modify or exclude the conditions, warranties and undertakings, or other legal rights under the Australian Consumer Law.
- 2.4 Subject to the terms and conditions of this Warranty, Platypus warrants that:
- 2.4.1 the Sprinkler is of acceptable quality; and
 - 2.4.2 is free from defects.
- 2.5 Subject to clause 2.1 above and the terms and conditions of the Warranty, Platypus agrees to repair or replace, at Platypus' expense the Sprinkler purchased by the Purchaser in Australia directly from Platypus or from a Platypus authorised distributor if and when the product does not perform in accordance with the manufacturer's specifications during the Term of the Warranty.

3. TERM

- 3.1 The Warranty is valid for one year from the date of purchase of the Platypus Sprinkler by the Purchaser.
- 3.2 The Date of Purchase of the Sprinkler is the date recorded on the receipt or invoice provided to the Purchaser at the time of purchase ("**Date of Purchase**").

4. MAKING A CLAIM

- 4.1 To make a claim under the Warranty the Purchaser must contact Platypus.
- 4.2 Platypus may be contacted with the following details:
- Customer Service
 - Platypus Fire Pty Ltd
 - PO Box 466
 - Trafalgar VIC 3824
 - Phone: 03 5644 3277
 - Email: info@platypussprinklers.com.au
 - Web: <http://platypussprinkler.com/c/contact-us>
- 4.3 The Purchaser must contact Platypus within a reasonable time of discovering the defect or fault.



4.4 When making a claim under this warranty the Purchaser must provide Platypus with the following details in writing:

- a. Any and all details necessary for Platypus to assess the claim, including but not limited to;
 - i. The date the defect or fault was identified;
 - ii. Proof of purchase such as a receipt or invoice;
 - iii. The nature of the fault or defect.

4.5 The Purchaser must cooperate with Platypus to make the Sprinkler available for evaluation by Platypus.

4.6 If the Purchaser is required to return the product to Platypus for repair, replacement or evaluation, Platypus will provide delivery details and a Return of Goods Authorization number to the purchaser.

5. REPAIR OR REPLACEMENT

5.1 Sprinklers may either be repaired or replaced at Platypus' discretion.

5.2 If a Sprinkler is to be replaced it may be replaced by products of similar design to the Sprinkler.

5.3 Platypus may engage a third party to replace or repair the Sprinkler at its sole discretion.

5.4 Replacement of the Sprinkler does not extend the Term of the Warranty.

5.5 If the Sprinkler was not installed by Platypus or its authorized agent, any travel costs or onsite labour costs incurred by Platypus to attend the property at which the Sprinkler is installed to repair or replace the Sprinkler will not be covered by the Warranty.

5.6 Platypus may seek reimbursement from the Purchaser of any costs incurred in the transport and evaluation of the Sprinkler if the Sprinkler is found to be in working order.

6. EXCLUSIONS

6.1 Subject to the terms of this warranty and to the extent permitted by law the Warranty does not apply in the following circumstances:

- a. the Sprinkler has not been installed, operated, maintained or used in accordance with Platypus' instructions or specifications;



*The Sensible Bushfire
Protection System*

- b. if damage, malfunction or failure of the Sprinkler has resulted from alteration, accident, misuse, abuse, fire, maladjustment of customer controls, use on an incorrect voltage, power surge and/or dips, thunderstorm activity, acts of God, flood, power supply problems, tampering or unauthorised repairs by any persons, use of defective or incompatible accessories, exposure to abnormally corrosive conditions or entry by any liquid, insect, vermin or foreign object into the Sprinkler;
 - c. if damage to the Sprinkler arises from or during transportation, installation (if installation is undertaken by a third party) or while moving the Sprinkler;
 - d. to any third party software or hardware not contained in the product as originally configured by the manufacturer.
 - e. to any failure of the Sprinkler that is not a failure of the Sprinkler to perform to its specifications.
 - f. to any replacement or repair of any lost parts or accessories.
 - g. service of the Sprinkler while it is outside Australia.
 - h. to any wear and tear if the Sprinkler is used for commercial, industrial, rural, educational or rental purposes.
- 6.2 Platypus is not liable for any loss or damage arising from alterations to third party hardware or software.
- 6.3 Platypus is not liable for any loss or damage arising from loss of use, loss of profits or revenue.
- 6.4 Platypus is not liable for any loss resulting from indirect or consequential loss or damage.

7 TRANSFER OF WARRANTY

- 7.2 This Warranty may be transferred to subsequent owners of the property on which the Sprinkler is installed in the event of the sale of that property.
- 7.3 To transfer this Warranty the Purchaser must notify Platypus, in writing, within a reasonable time of the sale of the property of the following details:
- 7.3.1 The name and contact details of the subsequent owner of the property; and
 - 7.3.2 The name and contact details of the previous owner of the property; and
 - 7.3.3 The date and place of purchase of the Sprinkler.
- 7.4 The transfer of this Warranty does not extend the Term of this Warranty.
- 7.5 The transfer of this Warranty does not alter in any way the terms and conditions of this Warranty.